



SPA AND RECREATIONAL FACILITIES

- Kriya Spa offers authentic Balinese treatments and an array of true healing experiences within the luxurious environment of 24 exotic spa villas.
- The Bay Club Fitness and Health Centre features a fully equipped gymnasium, an aerobics room, two air-conditioned squash courts, a whirlpool bath, a fitness centre pool, a steam room, a sauna and a plunge bath.
- The hotel features a 120 m lagoon pool, an outdoor river pool with a 50 m water slide and a Balinese feature pool.
- Three floodlit tennis courts, a nine-hole putting green, a jogging track and table tennis tables are also available. An 18-hole championship golf course is just five minutes away.
- Water sports facilities include snorkelling, windsurfing, catamarans, boogie boards. Deep-sea fishing, scuba diving, water-skiing, parasailing, fishing and outrigger sailing are all just ten minutes away.
- Kids Club is the hotel's children's activity centre

POINTS OF INTEREST

- Kintamani and Penelokan, Mount Batur
- Besakih, Bali's mother temple
- Tanah Lot, a sea temple
- Ubud, the center for Balinese painting and place of fine arts
- Celuk, a village known for gold and silver work
- Batuan, a center for the arts
- Goa Gajah, elephant cave and temple complex
- Sanur and Kuta beaches
- Denpasar city and the Bali museum

VISITOR INFORMATION

- All visitors entering Indonesia must possess a valid passport with a minimum of six months validity (contact your travel planner or airline for up-to-date visa requirements)
- Currency: Rupiah
- Climate: Tropical, with dry weather from April to October. The monsoon season is from November to March and features frequent rainfall
- Temperature: From 21°C to 33°C (70°F to 91°F).
- Voltage: 220v/50 cycles

TEMPLES

- Goa Lawah
- Tanah Lot
- Uluwatu temple
- Besakih

CONVENTION AND MEETING FACILITIES

- The resort has a total of 24 meeting rooms accommodating up to 1,420 people, as well as beachfront catering for up to 1,500 people.
- Creative coffee breaks and lunch arrangements for meetings and conferences are available.
- Spectacular on-site themed events, including Balinese weddings or banquets in various venues, can be arranged.

MEETING TECHNOLOGY

- Extensive audio visual facilities include a 3mx4m built-in screen, LCD projector, high-quality conference microphones and recording/mixing system with speakers.
- A full-time in-house audio visual team is on hand to assist with all technology requirements.

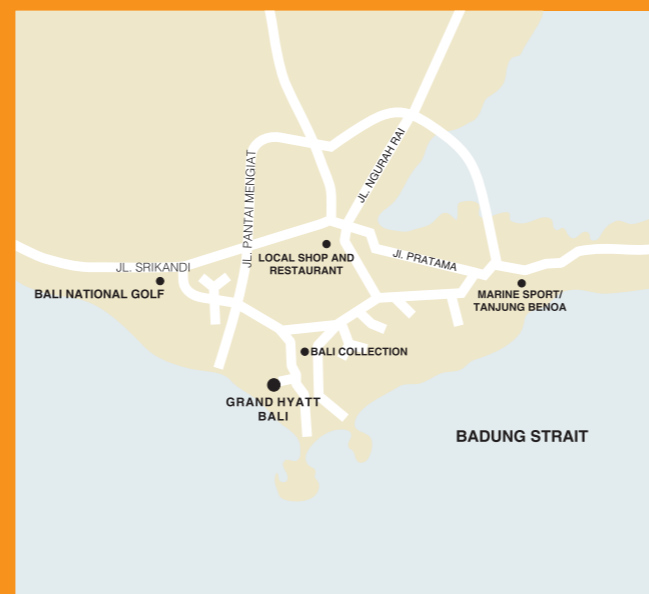

GRAND HYATT BALI

Kawasan Wisata Nusa Dua ITDC, Nusa Dua, Bali, Indonesia 80363

+ 62 361 77 1234 **TELEPHONE** + 62 361 77 2038 **FAX**

bali.grand@hyatt.com

grandhyattbali.com

GRAND | HYATT
BALI



GRAND HYATT BALI



LOCATION

Situated in Nusa Dua, Grand Hyatt Bali was conceived as a “water-palace” , with lakes, landscaped gardens and five swimming pools surrounding low-rise Balinese style buildings. The resort is just a short distance from Sanur, Kuta and the city of Denpasar.

TRANSPORTATION

FROM	DISTANCE	TIME	BY
Airport	12 km	15 mins	Car
City Centre	30 km	30 mins	Car

ACCOMMODATION

- A total of 636 rooms in four villages, including Grand Executive suites, Grand suites, Grand Club Executive suites, Ambassador suites, Belibis suite, Presidential suites and villas.
- All rooms have individually controlled air-conditioning, separate shower and bath, cable TV, international direct-dial telephone, personal safe, hairdryer and balcony.

GRAND CLUB™

The self-contained Grand Club Village has an open-air lounge and offers complimentary continental breakfast, all-day tea and coffee, evening cocktails, magazines, daily newspaper and a private swimming pool.

SERVICES AND FACILITIES

- Assistant Manager on duty 24 hours a day
- 24-hour Room Service
- Safety deposit boxes
- Babysitting service
- Laundry and dry-cleaning
- Beauty salon
- Florist
- Business centre services
- In-house clinic
- Shopping village
- Limousine and taxi service
- Multilingual hotel staff
- Valet car park
- Major credit cards accepted

RESTAURANTS AND BARS

- Pasar Senggol

Linger among an array of stalls offering authentic Indonesian and Balinese dishes, as well as artisans creating a host of handicrafts. Dine while being entertained by a legendary Balinese cultural performance.

- Garden Café

Surrounded by cascading waterfalls and lagoons, Garden Café is located close to the Lobby and serves Asian and Western comfort food.

- Nampu

Serving authentic Japanese cuisine in a completely serene ambience, Nampu offers a variety of dining experiences, including a Teppanyaki room and the main dining room, which serves fresh sushi, sashimi, yakitori and tempura, as well as Tatami rooms for private dining.

- Salsa Verde

This Italian beachside restaurant serves an array of seafood, pizzas, pastas and other Italian favourites.

- Watercourt

This traditional Balinese restaurant serves breakfast and is located among the water lily ponds of the West Village.

- Veranda Lounge & Bar

The ideal place to relax and enjoy the tropical breezes of Bali, Veranda Lounge & Bar is located off the Lobby and serves delightful refreshments and beverages.

- Salsa Bar

Situated on the rooftop of Salsa Verde, overlooking the Indian Ocean, the Salsa Bar serves cocktails and refreshments.

- Pool Bar

Located by the pool amid the tropical gardens and close to the beachfront, the Pool Bar features an array of original and classic cocktail blends and crushes.

ROOM DIMENSIONS AND CAPACITIES

ROOM	SIZE (M)	SIZE (FEET)	HEIGHT M/F	AREA (SQ M/SQ F)	THEATRE STYLE	CLASS ROOM	U SHAPE	BANQUET SET	COCKTAIL
GRAND BALLROOM I	27 X 14.5	90 X 48	8/27	392/4349	380	230	90	280	485
GRAND BALLROOM II	27 X 15	90 X 50	8/27	405/4499	480	270	90	320	500
GRAND BALLROOM III	27 X 15	90 X 50	8/27	405/4499	480	270	90	320	500
COMBINED	27 X 44.5	90 X 148	8/27	1202/13347	1420	800	-	970	1500
PRE-FUNCTION	12.5 X 30	42 X 115	4/13	431/4791	431	-	-	-	500
DRAWING ROOM									
RIJASA I	6 X 5	20 X 17	4/13	30/333	30	-	-	-	-
RIJASA II	6 X 5	20 X 17	4/13	30/333	30	-	-	-	-
COMBINED	12 X 5	40 X 17	4/13	57/667	60	-	-	-	-
MEETING ROOM									
BANGLI I	10 X 9	33 X 28	4/13	85/944	85	36	27	40	60
BANGLI II	10 X 9	33 X 28	4/13	85/944	85	36	27	40	60
COMBINED	10 X 17	33 X 57	4/13	170/1889	170	72	45	80	120
TABANAN I	10 X 8.5	33 X 28	4/13	85/944	85	36	27	40	60
TABANAN II	10 X 8.5	33 X 28	4/13	85/944	85	36	27	40	60
COMBINED	10 X 17	33 X 57	4/13	170/1889	170	72	45	80	120
BOARD ROOM									
JEPUN(16)	10 X 5	33 X 17	4/13	50/555	-	-	-	-	-
TUNJUNG(16)	10 X 5	33 X 17	4/13	50/555	-	-	-	-	-
KARANGASEM BALLROOM									
KARANGASEM I	19.5 X 10	65 X 33	6/20	195/2166	160	70	50	100	150
KARANGASEM II	19.5 X 11	65 X 37	6/20	215/2383	220	120	50	150	200
KARANGASEM III	19.5 X 11	65 X 38	6/20	224/2491	220	120	50	150	200
COMBINED	19.5 X 34	65 X 108	6/20	634/7040	750	350	160	400	600
PREFUNCTION	7.5 X 24	25 X 80	4.5/15	180/2000	-	-	-	-	150
MEETING ROOM									
BADUNG I	11 X 7.5	37 X 25	3/10	83/916	83	36	24	40	60
BADUNG II	11 X 7.5	37 X 25	3/10	83/916	83	36	24	40	60
COMBINED	11 X 15	37 X 50	3/10	165/1833	165	72	40	80	120
SINGARAJA I	11 X 7.5	37 X 25	3/10	83/916	83	36	24	40	60
SINGARAJA II	11 X 7.5	37 X 25	3/10	83/916	83	36	24	40	60
COMBINED	11 X 15	37 X 50	3/10	165/1833	165	72	40	80	120
KLUNGKUNG	10 X 15	33 X 50	3/10	150/1666	150	54	40	80	100
GIANYAR I	11 X 7.5	37 X 25	3/10	83/916	83	36	24	40	60
GIANYAR II	11 X 7.5	37 X 25	3/10	83/916	83	36	24	40	60
COMBINED	11 X 15	37 X 50	3/10	165/1833	165	72	40	80	120
NEGARA	10 X 14	33 X 47	5.5/18	140/1555	80	-	-	-	-
BOARD ROOM									
ANGSANA(15)	6.5 X 6.5	22 X 22	3/10	42/469	-	-	-	-	-
CEMPAKA(15)	7.5 X 7.5	25 X 25	3/10	56/625	-	-	-	-	-

FLOOR PLANS

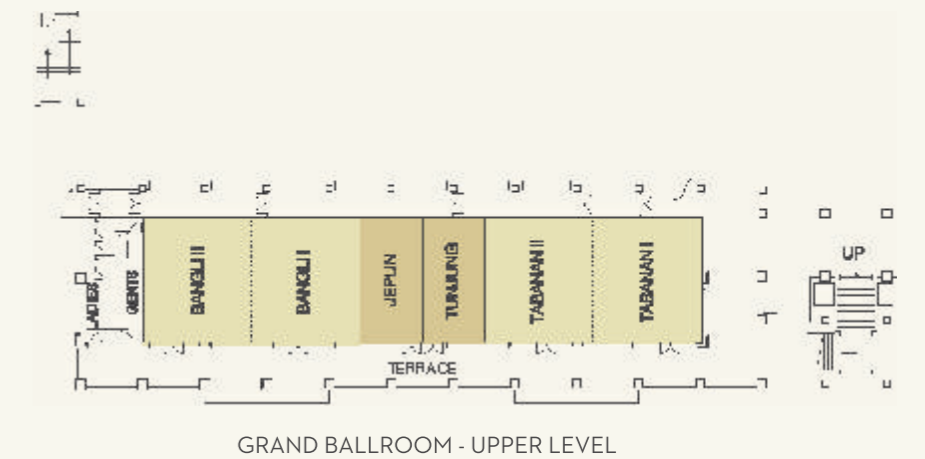

GRAND BALLROOM - UPPER LEVEL

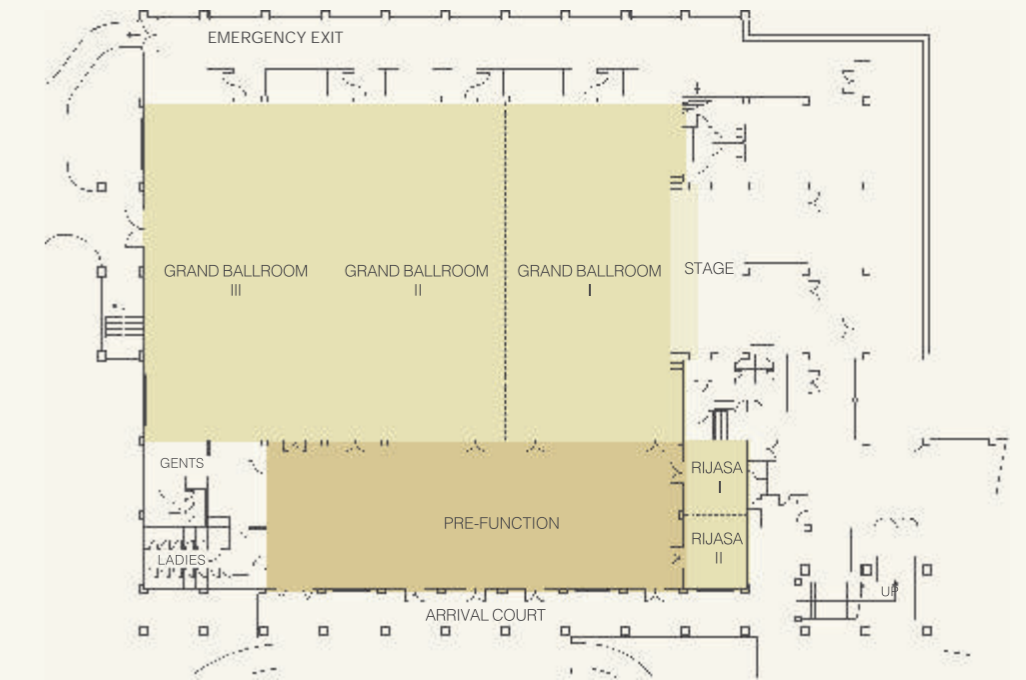

GRAND BALLROOM - LOWER LEVEL

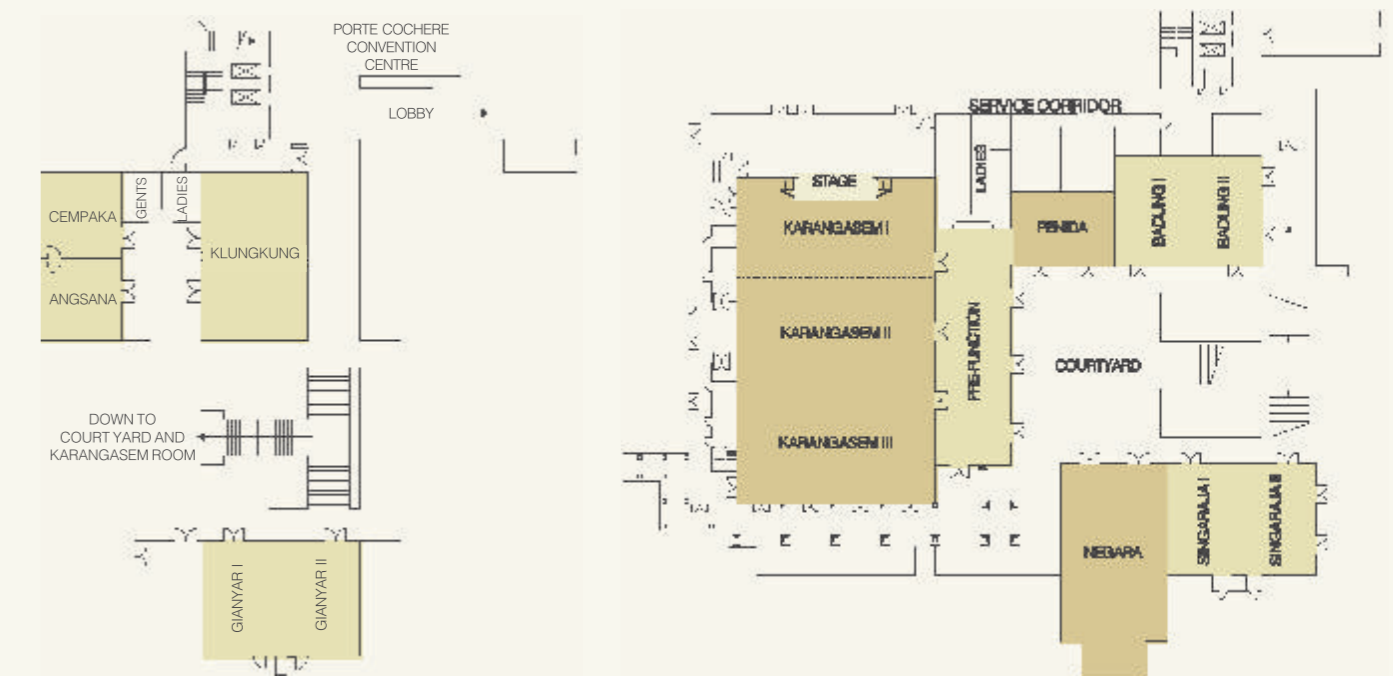

KARANGASEM BALLROOM - UPPER LEVEL

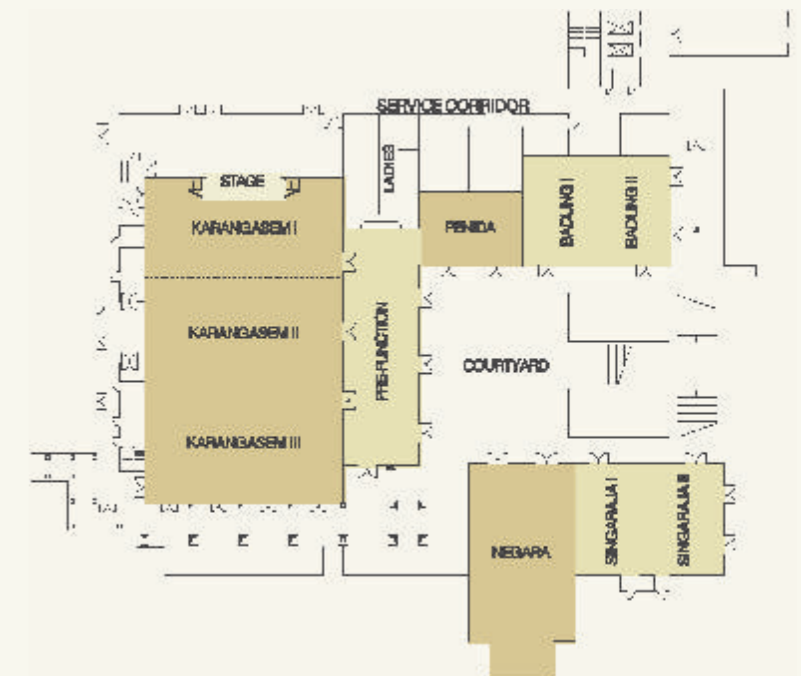

KARANGASEM BALLROOM - LOWER LEVEL